

**ALTERNATE CURB DESIGN FLAT GRADE STREETS  
(WHERE APPROVED) TO BE CONSIDERED WITH  
+/- 0.3% GUTTER GRADE**

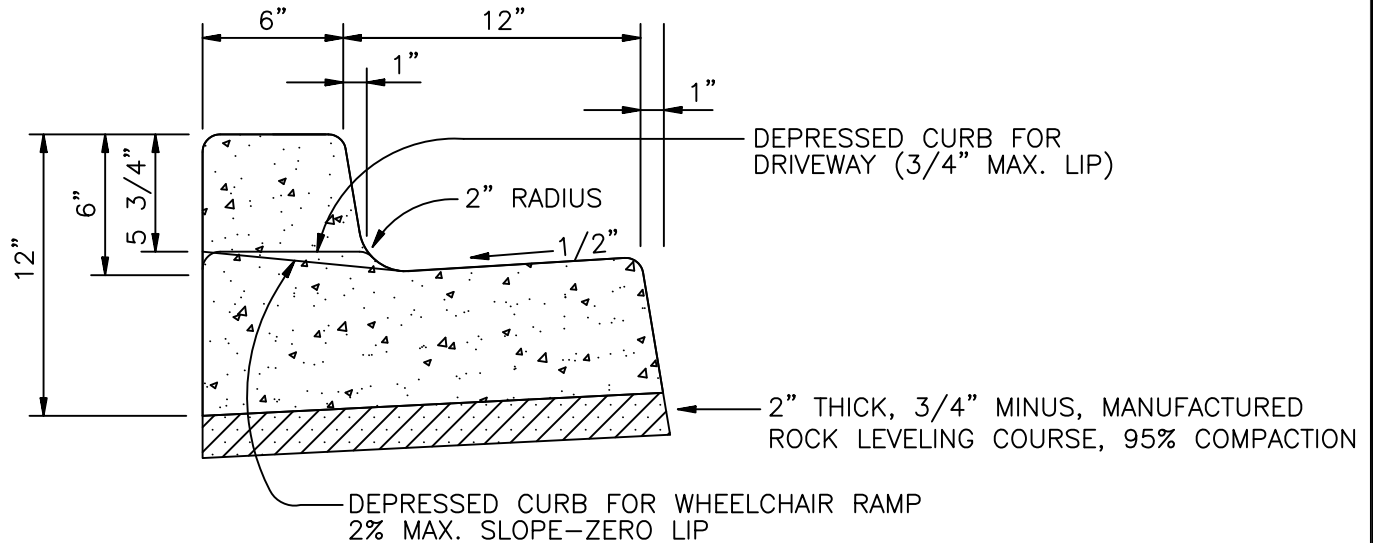

**TYPICAL CURB AND GUTTER**

**NOTES:**

1. ALL RADII SHALL BE 1/2" EXCEPT AS OTHERWISE SHOWN.
2. ISOLATION JOINTS SHALL BE PLACED ONLY AS SPECIFIED.
3. CONTRACTION JOINTS SHALL BE PLACED AT 15' INTERVALS AND SHALL BE AT LEAST 1 1/2" DEEP.
4. A CONTRACTION JOINT SHALL BE PLACED ALONG AND OVER WEEP HOLE THROUGH THE CURB AND THROUGH THE SIDEWALK.
5. WHEN SIDEWALKS ARE CONSTRUCTED, EXTEND 2" PIPE TO BACK OF SIDEWALK AND INSTALL COUPLING.
6. CURBS MUST BE FORMED FULL DEPTH BOTH SIDES, AND POURED SEPARATE FROM SIDEWALK. STREET DAMAGED SHALL BE SAW CUT AND REPAIRED TO MATCH EXISTING SURFACE.
7. EXISTING CONCRETE REMOVED DURING CONSTRUCTION SHALL BE SAW CUT PERPENDICULAR TO CURBLINE. NO SURFACE CONCRETE PATCH SHALL BE MADE.
8. BEFORE CONSTRUCTION BEGINS, A RIGHT OF WAY PERMIT MUST BE OBTAINED FROM THE ENGINEERING DIVISION AND EXISTING UTILITIES LOCATED.
9. BEFORE CONCRETE IS POURED, ENGINEERING DIVISION MUST INSPECT FORM WORK (48 HR. NOTICE REQUIRED).
10. ALL PORTLAND CEMENT CONCRETE SHALL BE 3500 PSI (6 SACK) WITH 4-7% ENTRAINED AIR AND A 4" MAXIMUM SLUMP.
11. CONCRETE PLACED FOR CURBS AND SIDEWALKS SHALL BE CURED WITH A TYPE 2 COMPOUND AND APPLIED AT RATE OF 1.1 GALLONS PER 150 SQ FT.
12. IF CONCRETE IS POURED WHEN TEMPERATURE DROPS BELOW 35 DEGREES F. DURING THE FIVE DAYS AFTER THE POUR, IT SHALL BE COVERED WITH INSULATING BLANKETS TO PROTECT CONCRETE FROM FREEZING.
13. BROOM FINISH CONCRETE PARALLEL TO THE STREET.
14. EXPANSION JOINTS SHALL BE PLACED AT:
  - A) EACH POINT OF TANGENCY OF CURVES.
  - B) EACH COLD JOINT
  - C) EACH SIDE OF INLET STRUCTURES.
  - D) EACH SIDE OF DRIVEWAY CUTS
  - E) AT 45' INTERVALS.
15. EXPANSION JOINT MATERIAL SHALL BE HOMEX BRAND OR APPROVED EQUAL.

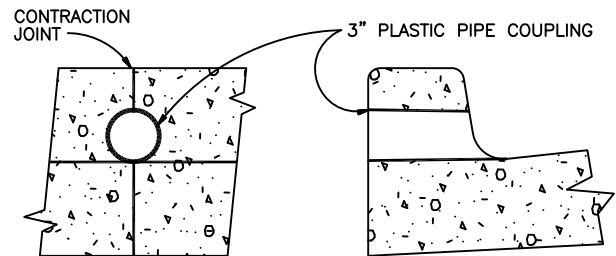

**WEEP HOLE THROUGH CURB**

**CITY OF LA GRANDE**

**CURB AND GUTTER STANDARDS**

QUESTIONS ? CALL ENGINEERING DIVISION 962-1333

DATE:

MARCH 2009

DRAWING NO.

**204 NYB**

POINTS OF IMPACT ARE BUMPER OR TAILPIPE

FACTOR OF SAFETY @ IMPACT POINT = 0.4 FT. TO ALLOW FOR FUTURE OVERLAYS, SURFACE IMPERFECTIONS, ICE, BROKEN BUMPERS AND TAIL PIPES, AND LOADED VEHICLES.

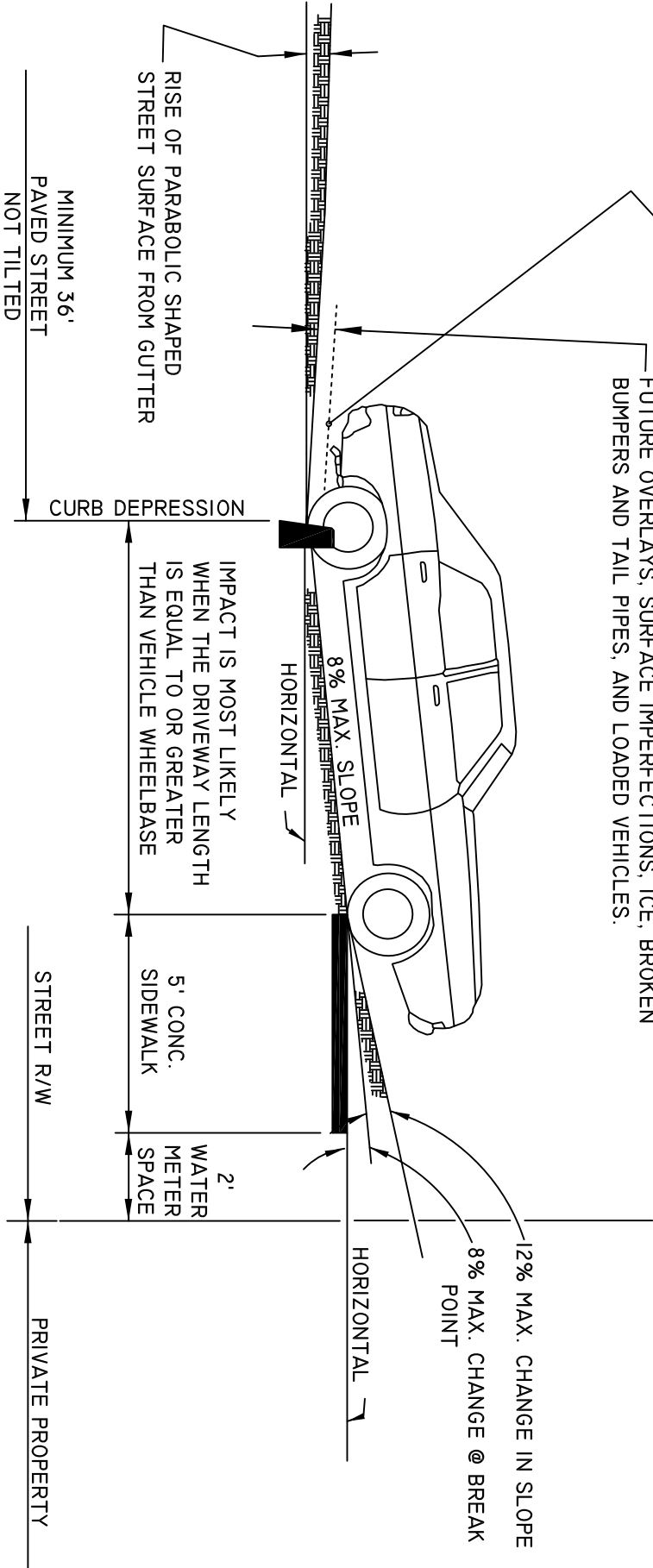

DRIVEWAY CONFIGURATION AND VEHICLE IMPACT

DRIVEWAY SLOPE STANDARD

CITY OF LA GRANDE

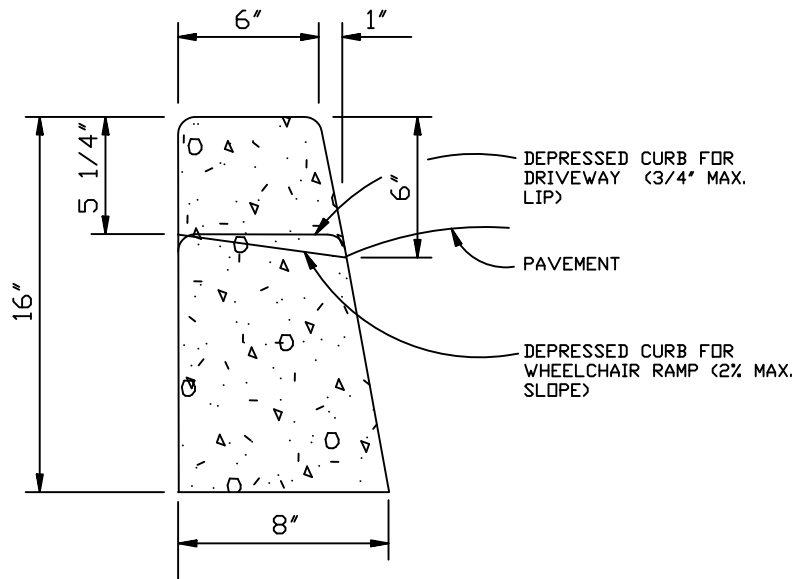

**STANDARD CURB CROSS SECTION**

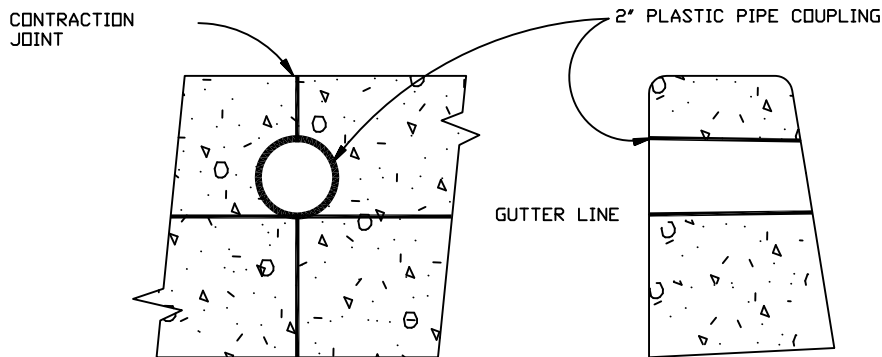

**WEEP HOLE THROUGH CURB**

**NOTES:**

1. ALL RADII SHALL BE 1/2" EXCEPT AS OTHERWISE SHOWN.
2. ISOLATION JOINTS SHALL BE PLACED ONLY AS SPECIFIED.
3. CONTRACTION JOINTS SHALL BE PLACED AT 15' INTERVALS AND SHALL EXTEND AT LEAST 50% THROUGH THE CURB OR CURB AND GUTTER.
4. A CONTRACTION JOINT SHALL BE PLACED ALONG AND OVER WEEP HOLE THROUGH THE CURB AND THROUGH THE SIDEWALK.
5. WHEN SIDEWALKS ARE CONSTRUCTED, EXTEND 2" PIPE TO BACK OF SIDEWALK AND INSTALL COUPLING.
6. CURBS MUST BE FORMED FULL DEPTH BOTH SIDES, AND POURED SEPARATE FROM SIDEWALK. STREET DAMAGED SHALL BE SAW CUT AND REPAIRED TO MATCH EXISTING SURFACE.
7. EXISTING CONCRETE REMOVED DURING CONSTRUCTION SHALL BE SAW CUT PERPENDICULAR TO CURBLINE.
8. BEFORE CONSTRUCTION BEGINS, A RIGHT OF WAY PERMIT MUST BE OBTAINED FROM THE ENGINEERING DIVISION AND EXISTING UTILITIES LOCATED.
9. BEFORE CONCRETE IS POURED, ENGINEERING DIVISION MUST INSPECT FORM WORK (48 HR. NOTICE REQUIRED).
10. CURB SECTIONS THROUGH DRIVEWAYS SHALL BE 3500 PSI (6 SACK MIX) IN 28 DAYS OF PORTLAND CEMENT CONCRETE WITH 4-7% ENTRAINED AIR AND 4" MAXIMUM SLUMP. OUTSIDE OF DRIVEWAY SECTIONS, CONCRETE SHALL BE 3,500 PSI (6 SACK MIX) IN 28 DAYS, 4%-7% ENTRAINED AIR, AND 4" MAXIMUM SLUMP.
11. CONCRETE PLACED FOR CURBS AND SIDEWALKS SHALL BE CURED AFTER PLACEMENT WITH A TYPE 2 COMPOUND AND APPLIED AT A MIN. RATE OF 1.1 GALLONS PER 150 SQ FT.
12. IF CONCRETE IS POURED WHEN TEMPERATURE DROPS BELOW 35 DEGREES F. DURING THE FIVE DAYS AFTER THE POUR, IT SHALL BE COVERED WITH INSULATING BLANKETS TO PROTECT CONCRETE FROM FREEZING.
13. BROOM FINISH CONCRETE PARALLEL TO THE STREET.

**CITY OF LA GRANDE**

**CURB AND CURB  
AND GUTTER  
STANDARDS**

QUESTIONS ? CALL ENGINEERING DIVISION 962-1333

DATE:

MARCH 2009

DRAWING NO.

203 NYB

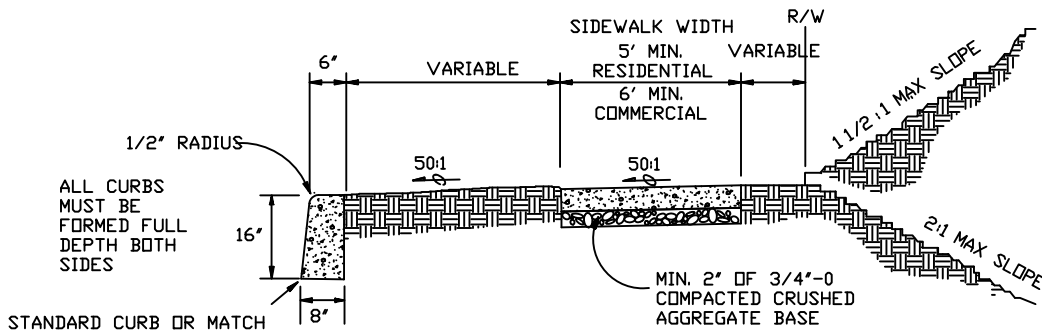

**TYPICAL CURB/SIDEWALK AND PLANTING STRIP CROSS SECTION**

**NOTE:**

CONCRETE FOR SIDEWALKS SHALL BE 4" MINIMUM DEPTH AND 3500 PSI. (6 SACK MIX)

SIDEWALKS THROUGH DRIVEWAYS SHALL BE 6" MINIMUM DEPTH AND 3500 PSI. (6 SACK MIX)

SEE DRIVEWAY APPROACH STANDARDS

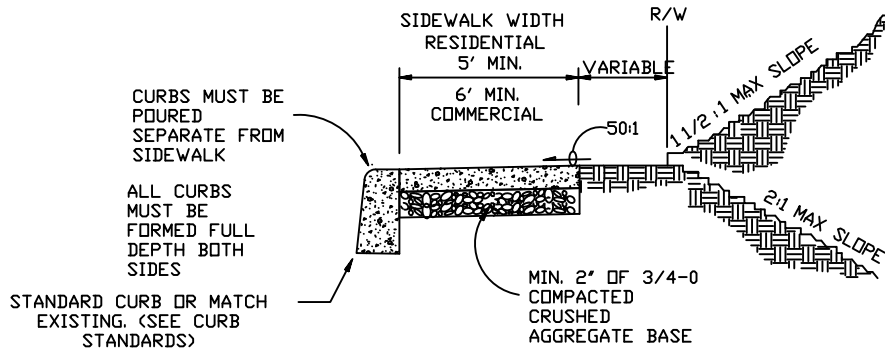

**TYPICAL CURB AND SIDEWALK CROSS SECTION**

BROOM FINISH CONCRETE SIDEWALKS PERPENDICULAR TO THE STREET, OR RADIALLY IN CURVED SECTIONS.

**NOTE:**

CONCRETE FOR SIDEWALKS SHALL BE 4" MIN. DEPTH AND 3500 PSI. (6 SACK MIX)

SIDEWALKS THROUGH DRIVEWAYS SHALL BE 6" MIN DEPTH AND 3500 PSI. (6 SACK MIX)

SEE DRIVEWAY APPROACH STANDARDS

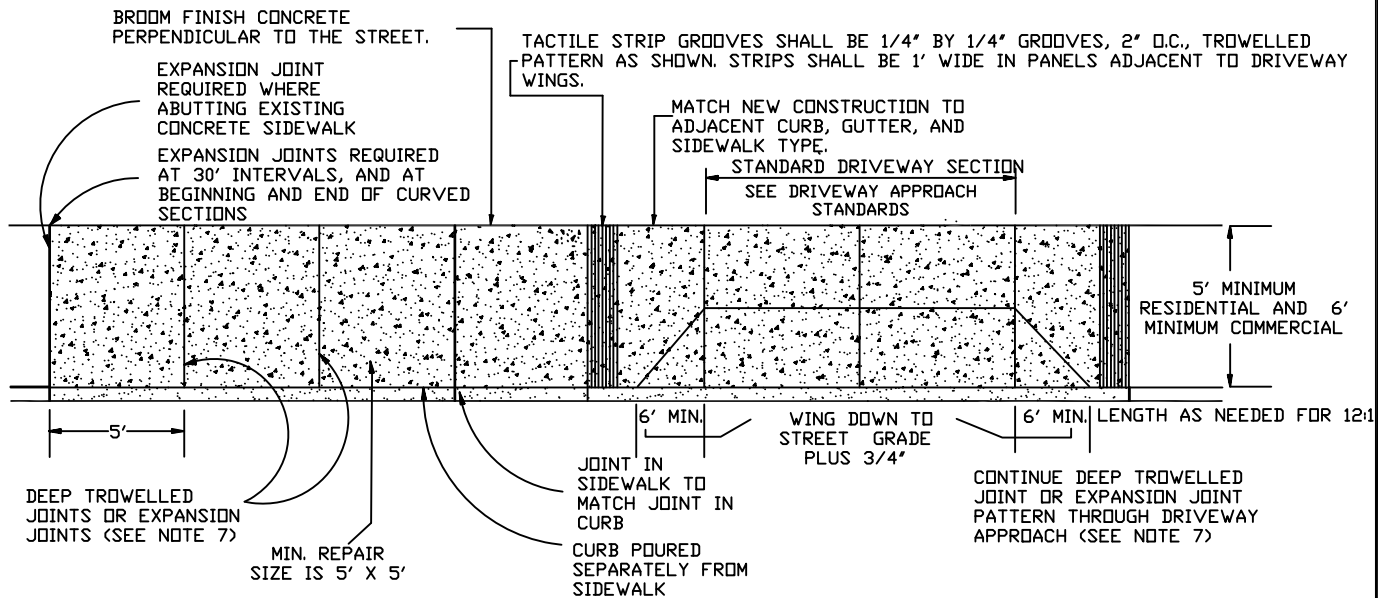

**CURB AND SIDEWALK PLAN VIEW**

**NOTES:**

1. SIDEWALKS 8 FEET AND WIDER SHALL HAVE A LONGITUDINAL CONTRACTION JOINT AT THE MIDPOINT.
2. CONCRETE TO BE USED SHALL BE 3500 (6 SACK MIX) P.S.I. IN 28 DAYS, HAVE 4%-7% ENTRAINED AIR, AND A 4" MAXIMUM SLUMP.
3. BEFORE ANY DRIVEWAY/SIDEWALK CONSTRUCTION BEGINS A RIGHT OF WAY PERMIT MUST BE OBTAINED FROM THE ENGINEERING DIVISION.
4. BEFORE CONCRETE IS POURED, ENGINEERING DIVISION MUST INSPECT FORM WORK (48 HOUR NOTICE REQUIRED).
5. CONCRETE WALKS, CURBS, AND DRIVEWAYS RE- MOVED DURING CONSTRUCTION MUST BE SAW CUT. ALL CUTS SHALL BE PERPENDICULAR TO THE CURB (OR RADIAL ON CURVES).
6. IF AN EXCAVATION FALLS WITHIN 30' OF AN EXISTING JOINT OR EDGE, THE CONCRETE SHALL BE REPLACED TO THE JOINT OR EDGE.
7. 1 1/2" DEEP TROWELLED JOINTS MAY BE SUBSTITUTED FOR EXPANSION JOINTS, EXCEPT WHEN ABUTTING EXISTING SIDEWALKS, OR AT 30' INTERVALS.
8. 15' MINIMUM SPACING BETWEEN DRIVEWAYS (UNLESS APPROVED BY ENGINEERING DIVISION)
9. STREET DAMAGED SHALL BE SAW CUT AND REPAIRED TO MATCH EXISTING SURFACE.
10. CONCRETE PLACED FOR SIDEWALKS SHALL BE CURED WITH A TYPE 2 CURING COMPOUND SHALL BE APPLIED AT A MIN. RATE OF 1.1 GALLONS PER 150 SQ FT.
11. IF CONCRETE IS POURED WHEN TEMPERATURE DROPS BELOW 35 DEGREES F. DURING THE FIVE DAYS AFTER THE POUR, IT SHALL BE COVERED WITH INSULATING BLANKETS TO PROTECT THE CONCRETE FROM FREEZING.
12. IN REPAIRS OR ALTERATIONS THE MIN. REPAIR IS A 5' X 5' SECTION.

**CITY OF LA GRANDE**

**SIDEWALK STANDARDS**

QUESTIONS ? CALL ENGINEERING DIVISION 962-1333

DATE:

MARCH 2009

DRAWING NO.

205 NYB

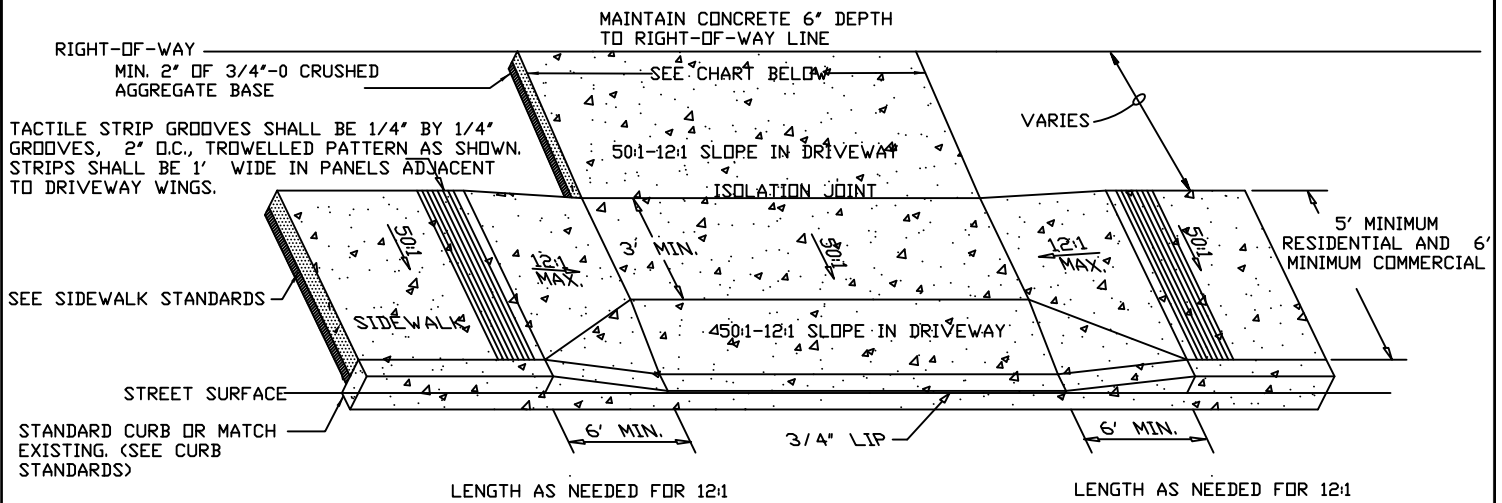

### DRIVEWAY APPROACH FOR CURB LINE SIDEWALK

TROWELLED JOINTS AT 5' INTERVALS (CONTINUE PATTERN THROUGH DRIVEWAY SECTION). (SEE NOTE 9)

BROOM FINISH CONCRETE PERPENDICULAR TO THE STREET, OR RADIALY IN CURVED SECTIONS.

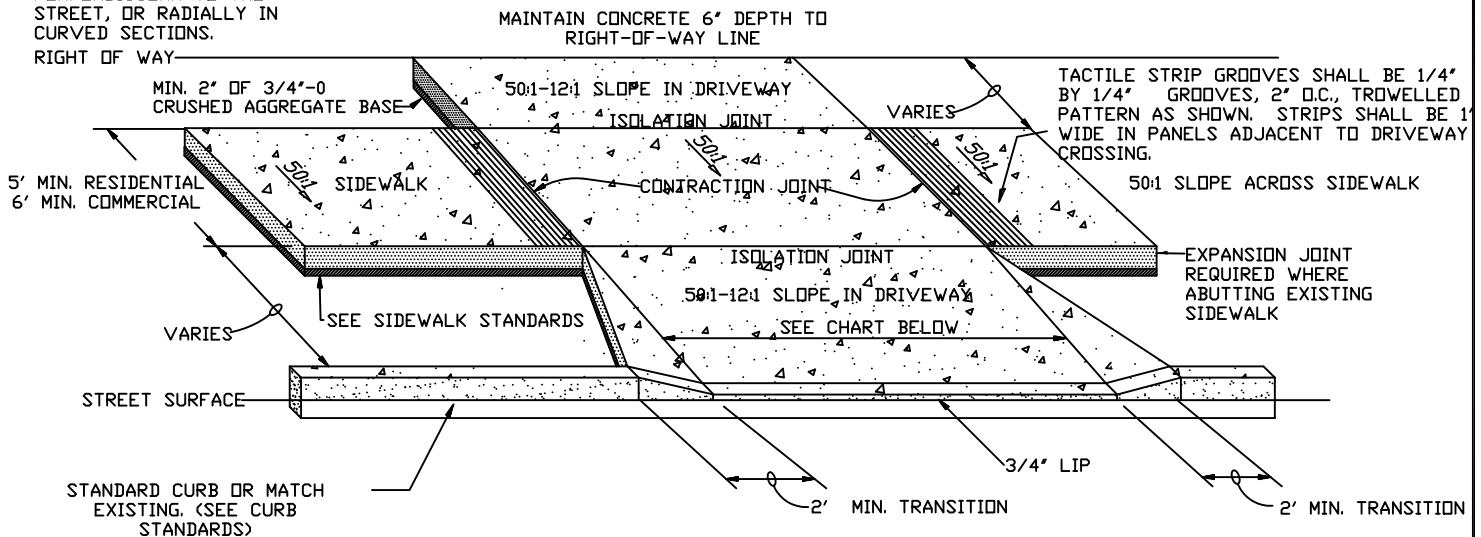

### DRIVEWAY APPROACH FOR SETBACK SIDEWALK

#### NOTES

1. DRIVEWAYS AND SIDEWALK SECTIONS THROUGH DRIVEWAYS SHALL BE 6" IN DEPTH OF 3500 PSI (6 SACK MIX) IN 28 DAYS OF PORTLAND CEMENT CONCRETE WITH 4 - 7% ENTRAINED AIR AND 4" MAXIMUM SLUMP.
2. CURBS MUST BE FORMED FULL DEPTH BOTH SIDES, AND POURED SEPARATE FROM APPROACH. STREET DAMAGED SHALL BE SAW CUT AND REPAIRED TO MATCH EXISTING SURFACE.
3. DRIVEWAY APPROACH CANNOT EXCEED 12:1 SLOPE WITHIN RIGHT-OF-WAY.
4. EXISTING CONCRETE REMOVED DURING CONSTRUCTION SHALL BE SAW CUT PERPENDICULAR TO CURB LINE.
5. MINIMUM OF 15' SEPARATION BETWEEN DRIVEWAYS, UNLESS APPROVED BY ENGINEERING.
6. BEFORE CONSTRUCTION BEGINS, A RIGHT OF WAY PERMIT MUST BE OBTAINED FROM THE ENGINEERING DIVISION, AND EXISTING UTILITIES LOCATED.
7. BEFORE CONCRETE IS POURED, ENGINEERING DIVISION MUST INSPECT FORM WORK. (48 HOUR NOTICE REQUIRED)
8. IF AN EXCAVATION FALLS WITHIN 30' OF AN EXISTING JOINT OR EDGE, THE CONCRETE SHALL BE REPLACED TO THE JOINT OR EDGE.
9. 1 1/2" DEEP TROWELLED JOINTS MAY BE SUBSTITUTED FOR EXPANSION JOINTS, EXCEPT WHEN ABUTTING EXISTING SIDEWALKS, OR AT 30' INTERVALS.
10. CONCRETE PLACED FOR CURBS AND SIDEWALKS SHALL BE CURED WITH A TYPE 2 COMPOUND AND BE APPLIED AT MIN. RATE OF 1.1 GALLONS PER 150 SQ FT.
11. IF CONCRETE IS POURED WHEN TEMPERATURE DROPS BELOW 35 DEGREES F. DURING THE FIVE DAYS AFTER THE POUR, IT SHALL BE COVERED WITH INSULATING BLANKETS TO PROTECT CONCRETE FROM FREEZING.

MAXIMUM DRIVEWAY WIDTH		
STREET FRONTAGE	COMMERCIAL	PRIVATE
LESS THAN 30'	15'	10'
30' TO 50'	25'	14'
50' TO 75'	35'	25'
75' TO 100'	35'	25'
MINIMUM DRIVEWAY WIDTH IS 10'		

## CITY OF LA GRANDE

### DRIVEWAY APPROACH STANDARDS

QUESTIONS ? CALL ENGINEERING DIVISION 962-1333

DATE:

MARCH 2009

DRAWING NO.

208 NYB

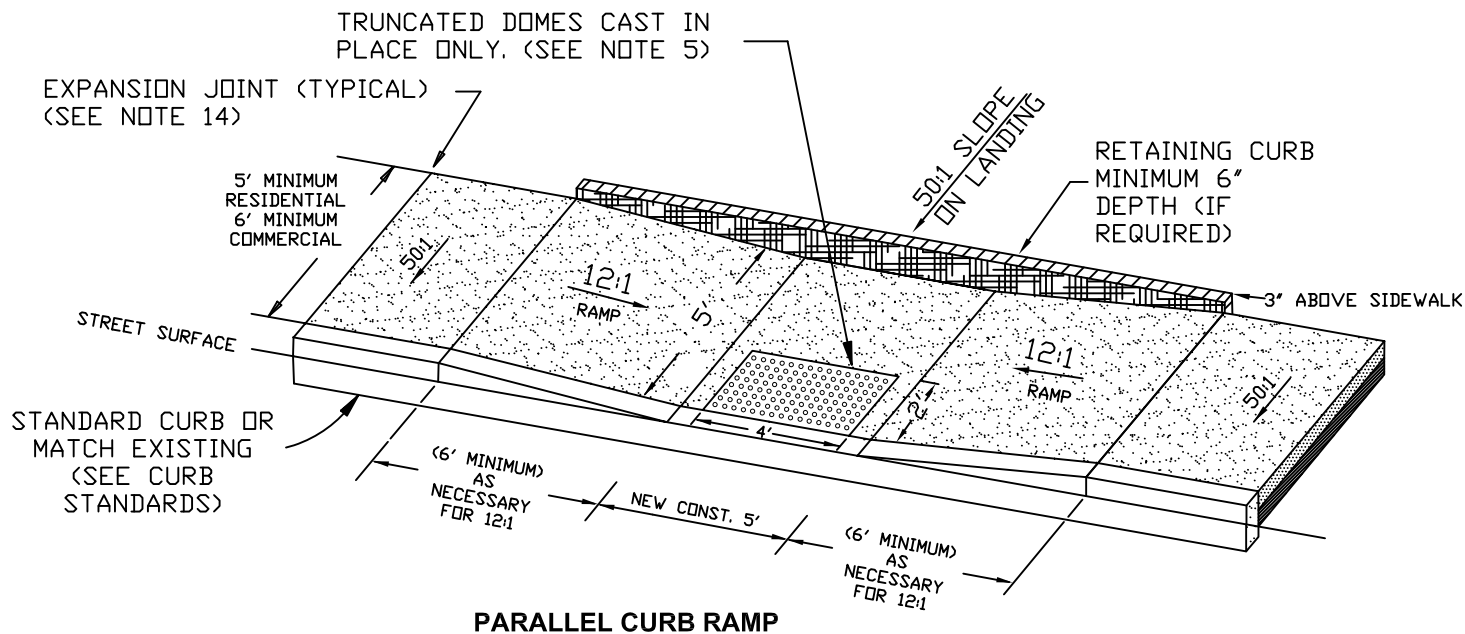

### PARALLEL CURB RAMP

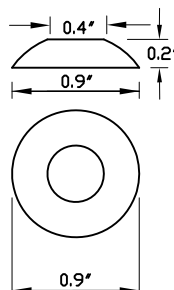
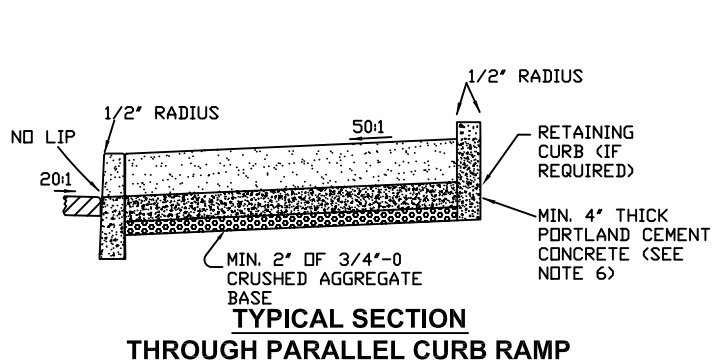

**TRUNCATED DOME  
DETAIL**

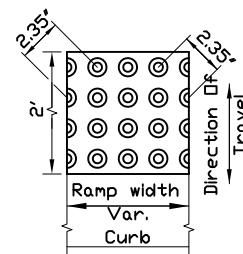

**RAMP TEXTURE PATTERN  
DETAIL**

#### NOTES

1. THE "AMERICANS WITH DISABILITIES ACT" (ADA) REQUIRES THAT ACCESS RAMPS TO SIDEWALKS CONFORM TO ALL FEDERAL GUIDELINES. EXCEPTIONS TO THE REQUIREMENTS IN THIS DRAWING MUST BE APPROVED BY THE CITY AND MUST COMPLY WITH A.D.A.
2. NO ABOVE GROUND UTILITIES ARE PERMITTED WITHIN RAMP AREA.
3. LANDING SLOPES SHALL NOT EXCEED 50:1 IN ANY DIRECTION. THE SLOPE OF THE SURFACING AT THE BOTTOM OF THE RAMP SHALL NOT EXCEED 20:1 FOR A DISTANCE OF 2' (SEE TYPICAL SECTION ABOVE).
4. MINIMUM LANDING DIMENSIONS SHALL BE 5'x 5'.
5. PLACE TRUNCATED DOME DETECTABLE WARNING TEXTURE IN THE LOWER 2' OF THROAT OF RAMP ONLY. ARRANGE DOMES USING IN-LINE PATTERN AS SHOWN IN DETAIL ABOVE. COLOR OF TEXTURE TO BE SAFETY YELLOW. MUST BE CAST IN PLACE ONLY.
6. CONCRETE TO BE USED SHALL BE 3500 P.S.I. (6 SACK MIX) IN 28 DAYS, HAVE 4%-7% ENTRAINED AIR, AND A 4" MAXIMUM SLUMP.
7. CURBS MUST BE FORMED FULL DEPTH BOTH SIDES, AND POURED SEPARATE FROM SIDEWALK. STREET DAMAGED SHALL BE SAW CUT AND REPAIRED TO MATCH EXISTING SURFACE.
8. EXISTING CONCRETE REMOVED DURING CONSTRUCTION SHALL BE SAW CUT PERPENDICULAR TO CURBLINE.
9. BEFORE CONSTRUCTION BEGINS, A RIGHT OF WAY PERMIT MUST BE OBTAINED FROM THE ENGINEERING DIVISION AND EXISTING UTILITIES LOCATED.
10. BEFORE CONCRETE IS POURED, ENGINEERING DIVISION MUST INSPECT FORM WORK (48 HR. NOTICE REQUIRED).
11. CONCRETE PLACED FOR CURBS AND SIDEWALKS SHALL BE CURED WITH A TYPE 2 COMPOUND AND SHALL BE APPLIED AT MIN. RATE OF 1.1 GALLONS PER 150 SQ FT.
12. IF CONCRETE IS POURED WHEN TEMPERATURE DROPS BELOW 35 DEGREES F., DURING THE FIVE DAYS AFTER THE POUR, IT SHALL BE COVERED WITH INSULATING BLANKETS TO PROTECT CONCRETE FROM FREEZING.
13. BROOM FINISH CONCRETE SIDEWALKS PERPENDICULAR TO THE STREET, OR RADIALLY IN CURVED SECTIONS.

CITY OF LA GRANDE

MID-BLOCK  
SIDEWALK  
ACCESS RAMPS

QUESTIONS ? CALL ENGINEERING DIVISION 962-1333

DATE:  
MARCH 2009

DRAWING NO.  
206 NYB

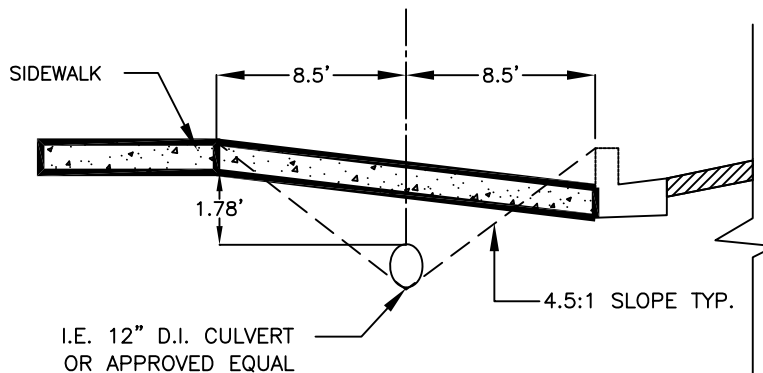

SECTION B

BROOM FINISH CONCRETE  
PERPENDICULAR TO THE  
STREET, OR RADIALY IN  
CURVED SECTIONS.  
RIGHT OF WAY

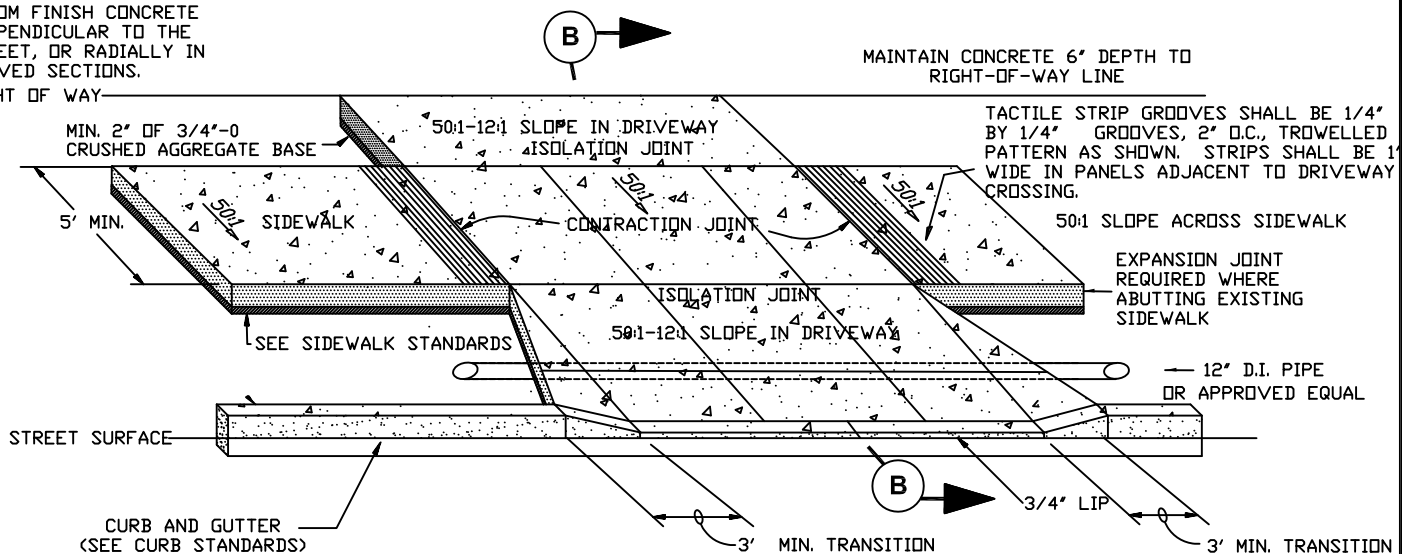

DRIVEWAY APPROACH FOR SETBACK SIDEWALK

**NOTES**

1. DRIVEWAYS AND SIDEWALK SECTIONS THROUGH DRIVEWAYS SHALL BE 6" IN DEPTH OF 3500 PSI (6 SACK MIX) IN 28 DAYS OF PORTLAND CEMENT CONCRETE WITH 4 - 7% ENTRAINED AIR AND 4" MAXIMUM SLUMP.
2. CURBS MUST BE FORMED FULL DEPTH BOTH SIDES, AND POURED SEPARATE FROM APPROACH. STREET DAMAGED SHALL BE SAW CUT AND REPAIRED TO MATCH EXISTING SURFACE.
3. DRIVEWAY APPROACH CANNOT EXCEED 12:1 SLOPE WITHIN RIGHT-OF-WAY.
4. EXISTING CONCRETE REMOVED DURING CONSTRUCTION SHALL BE SAW CUT PERPENDICULAR TO CURB LINE.
5. MINIMUM OF 15' SEPARATION BETWEEN DRIVEWAYS, UNLESS APPROVED BY ENGINEERING.
6. BEFORE CONSTRUCTION BEGINS, A RIGHT OF WAY PERMIT MUST BE OBTAINED FROM THE ENGINEERING DIVISION, AND EXISTING UTILITIES LOCATED.
7. BEFORE CONCRETE IS POURED, ENGINEERING DIVISION MUST INSPECT FORM WORK. (48 HOUR NOTICE REQUIRED)
8. IF AN EXCAVATION FALLS WITHIN 30' OF AN EXISTING JOINT OR EDGE, THE CONCRETE SHALL BE REPLACED TO THE JOINT OR EDGE.
9. EXPANSION JOINTS ARE REQUIRED WHEN ABUTTING EXISTING SIDEWALKS OR AT 30' INTERVALS.
10. CONCRETE PLACED FOR CURBS AND SIDEWALKS SHALL BE CURED WITH A TYPE 2 COMPOUND AND BE APPLIED AT MIN. RATE OF 1.1 GALLONS PER 150 SQ FT.
11. IF CONCRETE IS POURED WHEN TEMPERATURE DROPS BELOW 35 DEGREES F. DURING THE FIVE DAYS AFTER THE POUR, IT SHALL BE COVERED WITH INSULATING BLANKETS TO PROTECT CONCRETE FROM FREEZING.

MINIMUM DRIVEWAY WIDTH IS 12'  
MAXIMUM DRIVEWAY WIDTH IS 35'

**CITY OF LA GRANDE**

**BUSINESS PARK  
DRIVEWAY APPROACH  
STANDARDS**

QUESTIONS ? CALL ENGINEERING DIVISION 962-1333

DATE:

MARCH 2009

DRAWING NO.

208-A NYB

206-A NYB



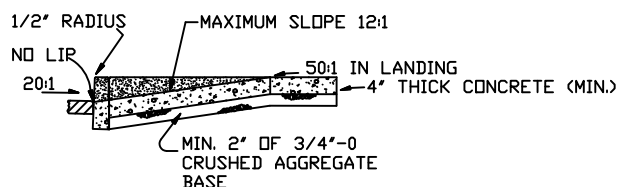
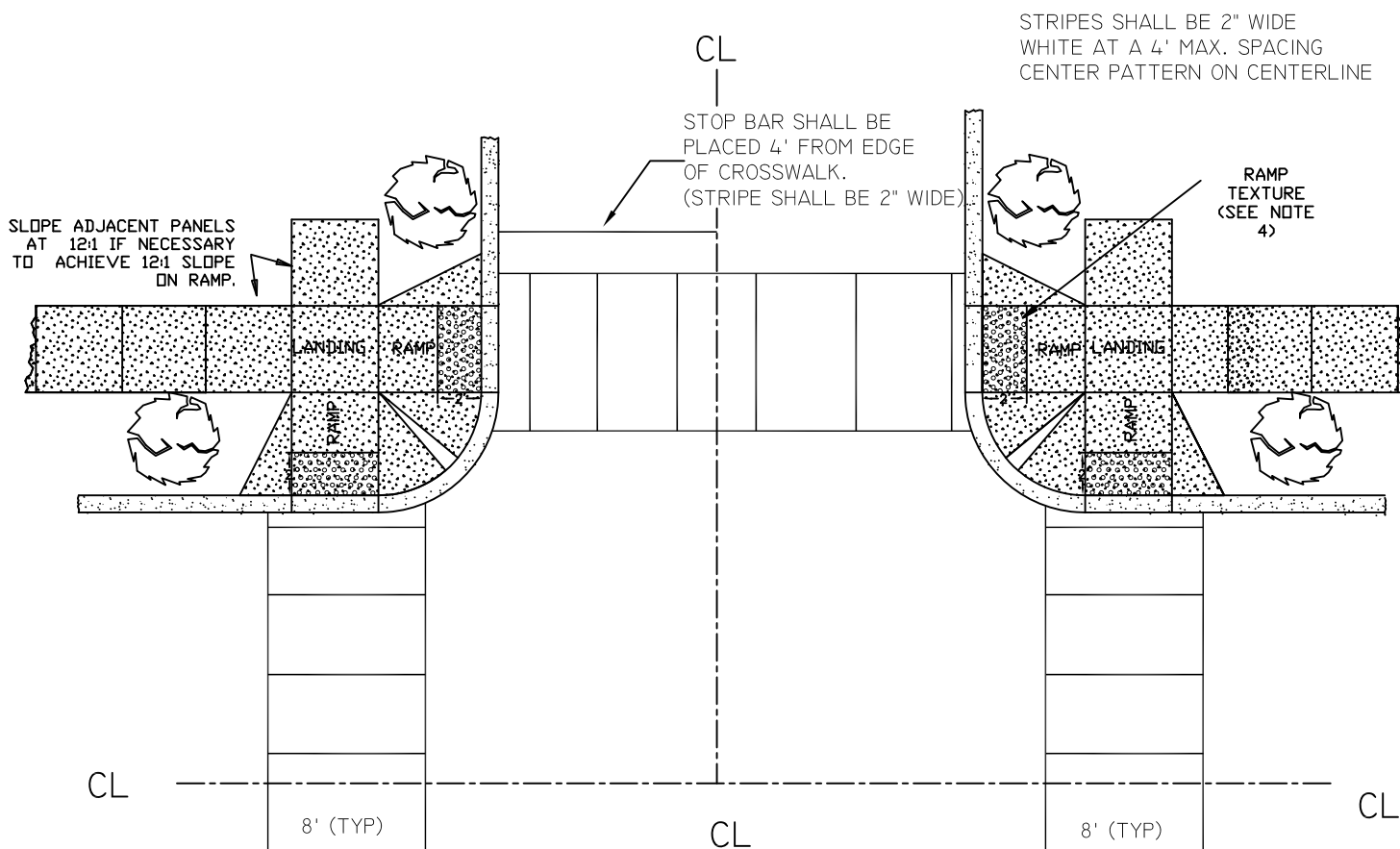

**TYPICAL RAMP CROSS SECTION**

EXPANSION JOINT REQUIRED WHERE ABUTTING EXISTING SIDEWALK

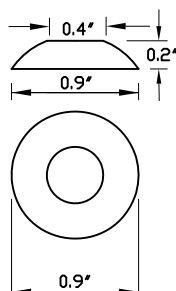

**TRUNCATED DOME DETAIL**

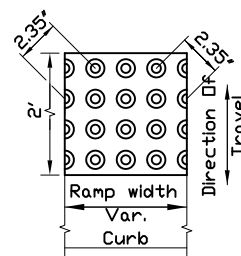

**RAMP TEXTURE PATTERN DETAIL**

**NOTES**

1. BROOM FINISH CONCRETE SIDEWALKS PERPENDICULAR TO THE STREET, OR RADially IN CURVED SECTIONS.
2. LANDINGS SHALL BE PLACED AT THE TOP OF EACH RAMP. LANDING SLOPE SHALL NOT EXCEED 50:1 IN ANY DIRECTION. THE SLOPE OF THE SURFACING AT THE BOTTOM OF THE RAMP SHALL NOT EXCEED 20:1 FOR A DISTANCE OF 2' (SEE TYPICAL SECTION ABOVE).
3. MINIMUM LANDING DIMENSIONS SHALL BE 5'x 5'.
4. PLACE TRUNCATED DOME DETECTABLE WARNING TEXTURE IN THE LOWER 2' OF THROAT OF RAMP ONLY. ARRANGE DOMES USING IN-LINE PATTERN AS SHOWN IN THE DETAIL ABOVE. COLOR OF TEXTURE TO BE SAFETY YELLOW. MUST BE CAST IN PLACE ONLY.
5. CURBS MUST BE FORMED FULL DEPTH BOTH SIDES, AND POURED SEPARATE FROM SIDEWALK. STREET DAMAGED SHALL BE SAW CUT AND REPAIRED TO MATCH EXISTING SURFACE.
6. EXISTING CONCRETE REMOVED DURING CONSTRUCTION SHALL BE SAW CUT PERPENDICULAR TO CURB LINE.

**CITY OF LA GRANDE**

**CORNER SIDEWALK  
ACCESS RAMPS AND  
CROSSWALK DETAIL**

QUESTIONS ? CALL ENGINEERING DIVISION 962-1333

DATE:

JAN. 2006

DRAWING NO.

206-NYB

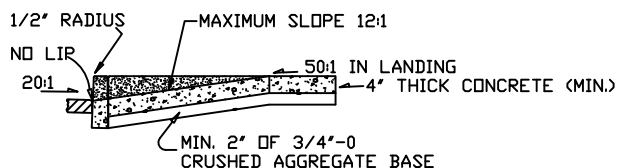

**TYPICAL RAMP CROSS SECTION**

EXPANSION JOINT  
REQUIRED WHERE  
ABUTTING EXISTING  
SIDEWALK

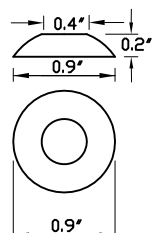

**TRUNCATED DOME  
DETAIL**

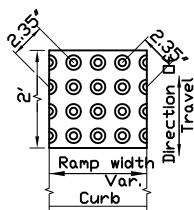

**RAMP TEXTURE PATTERN  
DETAIL**

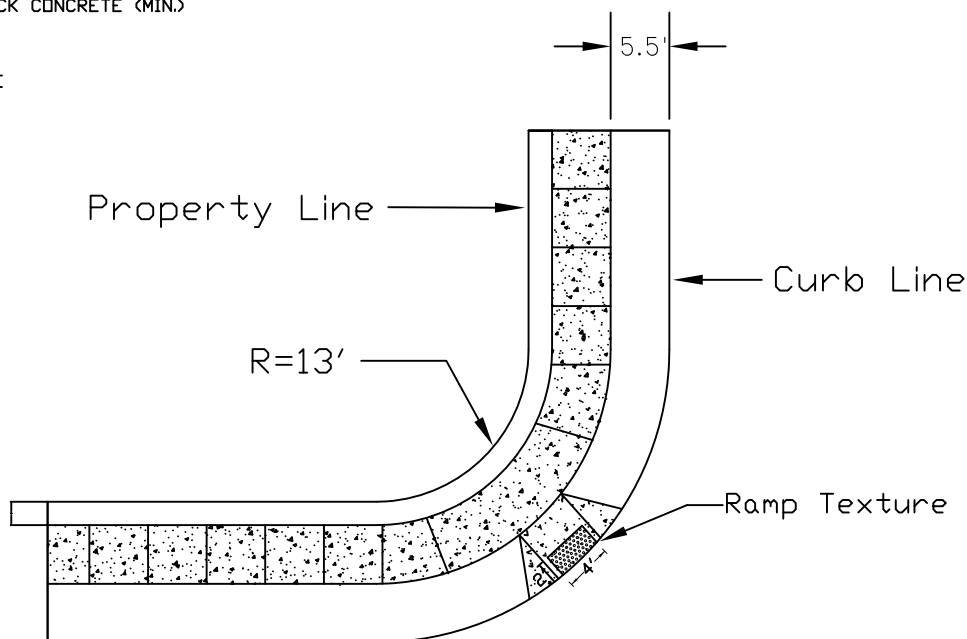

## **PERPENDICULAR CURB RAMPS**

### **NOTES:**

1. THE "AMERICANS WITH DISABILITIES ACT" (A.D.A.) REQUIRES THAT ACCESS RAMPS TO SIDEWALKS CONFORM TO ALL FEDERAL GUIDELINES. EXCEPTIONS TO THE REQUIREMENTS IN THIS DRAWING MUST BE APPROVED BY THE ENGINEER AND MUST COMPLY WITH A.D.A. REQUIREMENTS.
2. IF CONCRETE IS POURED WHEN TEMPERATURE DROPS BELOW 35 DEGREES F. DURING THE FIVE DAYS AFTER THE POUR, IT SHALL BE COVERED WITH INSULATING BLANKETS TO PROTECT CONCRETE FROM FREEZING.
3. BROOM FINISH CONCRETE SIDEWALKS PERPENDICULAR TO THE STREET, OR RADIALLY IN CURVED SECTIONS.
4. CONCRETE PLACED FOR CURBS AND SIDEWALKS SHALL BE CURED WITH A TYPE 2 COMPOUND AND BE APPLIED AT A MIN. RATE OF 1.1 GALLONS PER 150 SQ. FT.
5. NO ABOVE GROUND UTILITIES ARE PERMITTED WITHIN RAMP AREA.
6. LANDINGS SHALL BE PLACED AT THE TOP OF EACH RAMP. LANDING SLOPE SHALL NOT EXCEED 50:1 IN ANY DIRECTION. THE SLOPE OF THE SURFACING AT THE BOTTOM OF THE RAMP SHALL NOT EXCEED 20:1 FOR A DISTANCE OF 2' (SEE TYPICAL SECTION ABOVE).
7. MINIMUM LANDING DIMENSIONS SHALL BE 5'x 5'.
8. PLACE TRUNCATED DOME DETECTABLE WARNING TEXTURE IN THE LOWER 2' OF THROAT OF RAMP ONLY. ARRANGE DOMES USING IN-LINE PATTERN AS SHOWN IN THE DETAIL ABOVE. COLOR OF TEXTURE TO BE SAFETY YELLOW. MUST BE CAST IN PLACE ONLY.
9. CONCRETE TO BE USED SHALL BE 3500 P.S.I. (6 SACK MIX) IN 28 DAYS, HAVE 4%-7% ENTRAINED AIR, AND A 4" MAXIMUM SLUMP.
10. CURBS MUST BE FORMED FULL DEPTH BOTH SIDES, AND POURED SEPARATE FROM SIDEWALK. STREET DAMAGED SHALL BE SAW CUT AND REPAIRED TO MATCH EXISTING SURFACE.
11. EXISTING CONCRETE REMOVED DURING CONSTRUCTION SHALL BE SAW CUT PERPENDICULAR TO CURB LINE.
12. BEFORE CONSTRUCTION BEGINS, A RIGHT OF WAY PERMIT MUST BE OBTAINED FROM THE ENGINEERING DIVISION AND EXISTING UTILITIES LOCATED.
13. BEFORE CONCRETE IS POURED, ENGINEERING DIVISION MUST INSPECT FORM WORK (48 HR. NOTICE REQUIRED).

**CITY OF LA GRANDE**

**CORNER SIDEWALK  
ACCESS RAMPS**

QUESTIONS ? CALL ENGINEERING DIVISION 962-1333

DATE:

MARCH 2009

DRAWING NO.

206-B NYB